

# INDUSTRIAL STRAINER



[www.mss21.co.kr](http://www.mss21.co.kr)



Strainer manufacturer  
**Myungseong  
Industrial Corp.**

# Strainer manufacturer : Myungseong Industrial

Greetings!

Myungseong is specialized in manufacturing environment-related strainer, injection molding and Teflon products and is growing further with long experience in the field and technologies based on know-hows.

Myungseong is dedicated to customer management and satisfaction to supply the best quality products at reasonable prices, fast delivery and A/S as well as to develop new products and production system.

Myungseong will continue to follow the path of a leading company facing challenges along the way. We hope for closer communication with our customers and their support.

Thank you.

Myungseong employees

## INDEX

- MSS—For pure water ..... 3
- MSS—For clean water ..... 4
- MSS—For filtering ..... 5
- MSS—Separable type ..... 6~9
- MSS—Injection type ..... 10
- MSS—Disc separable type ..... 11
- MSS—W for pure water ..... 12
- MSS—Block type ..... 13~14
- MSS—SUS strainer ..... 15~17
- MSS—Air diffuser data sheet ..... 18~19



[www.mss21.co.kr](http://www.mss21.co.kr)



# MSS-FOR PURE WATER

Model : MS1000A

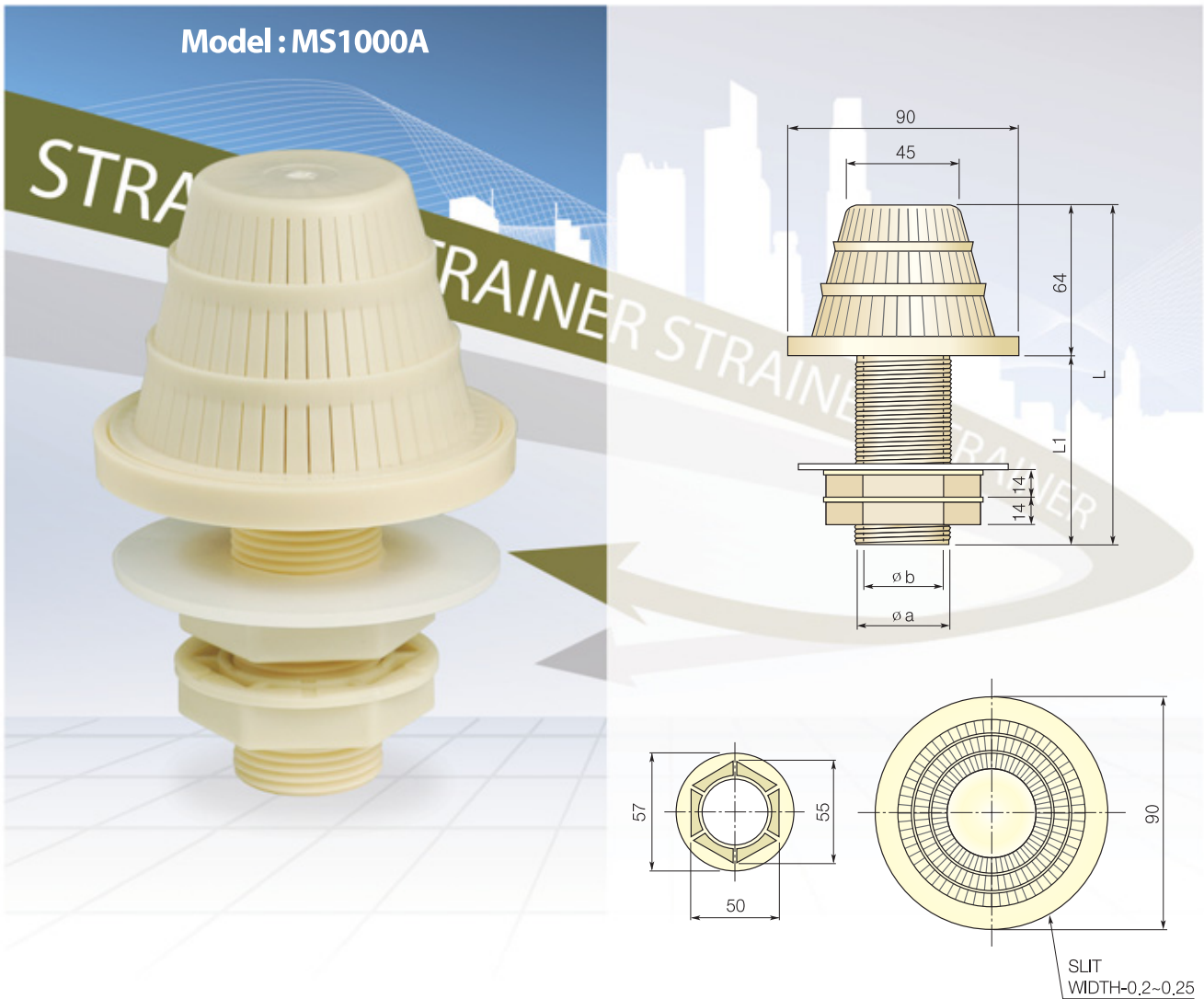

## Strainer specifications and design requirements

Name	MSS Strainer for pure water	Height	L-134mm
Type	Parasol close type		L <sub>1</sub> -70mm
Use	For ion resin	Port diameters	Ⓐ External diameter 32Ø Internal diameter 25Ø
Flow rate	1.2m <sup>3</sup> /H (1.2 Ton per hour)		Ⓑ External diameter 26Ø Internal diameter 20Ø
Heat deflection temperature	PP 90°C ~ 100°C	Slit width	0.25mm × 45EA × 3
	ABS 86°C		
Materials	Polypro pylene (Coprene complex P.P) Acrylonitrile butadiene styrene (ABS 740)		

### Test tank pressure 2K

- When the pressure applied, the flow rate was approx. 1.2m<sup>3</sup>/H (1.2 Ton per hour).
- Remove foreign substances when insufficient flow rate while using the strainer

# MSS-FOR CLEAN WATER

Model : MS1000C

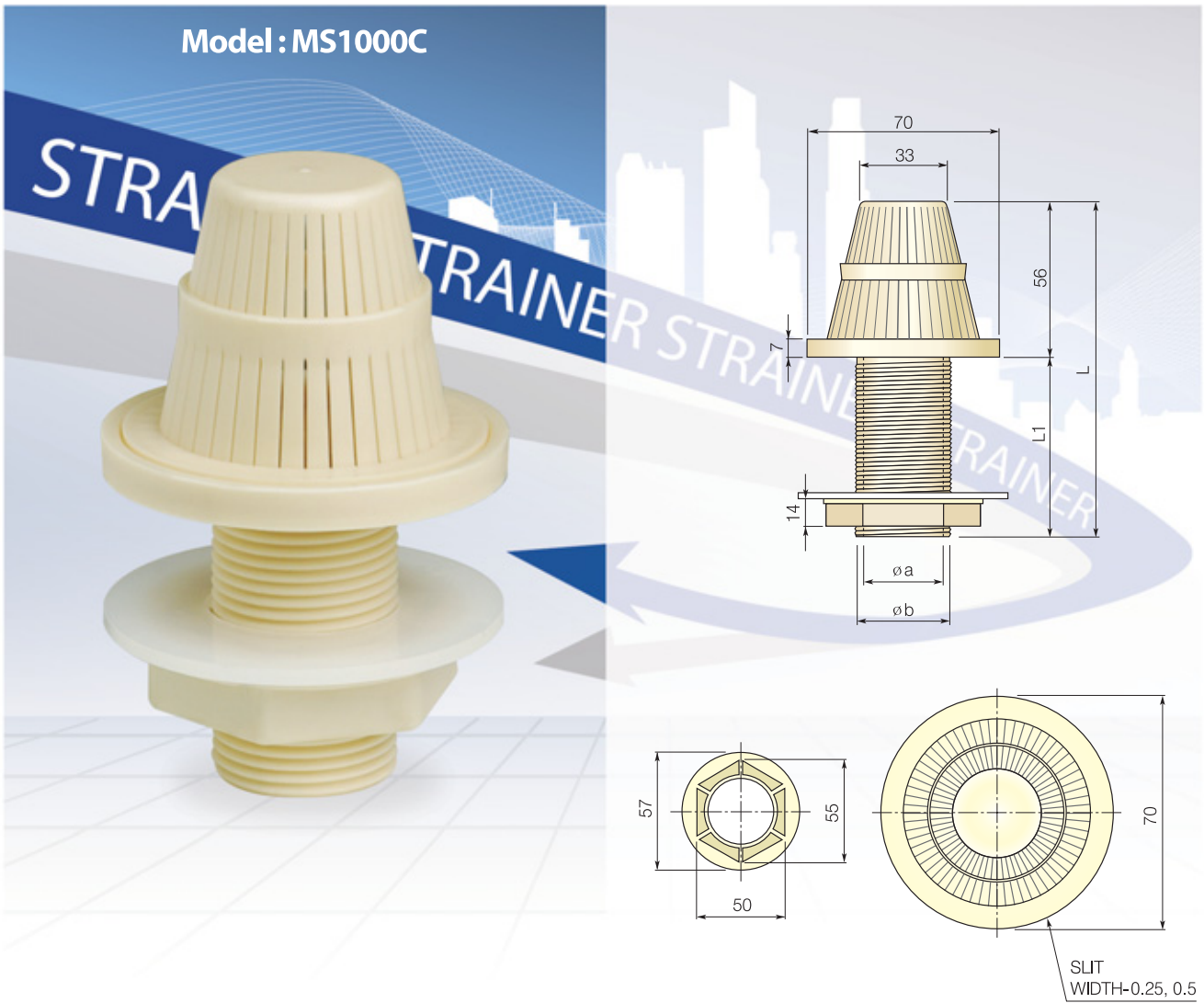

## Strainer specifications and design requirements

Name	MSS Strainer for clean water	Height	L-111mm
Type	Parasol close type		L1-55mm
Use	Purifying and filtering of clean water	Port diameters	Ⓐ External diameter 26Ø Internal diameter 20Ø
Flow rate	1.0m <sup>3</sup> /H (1.0 Ton per hour) 0.6m <sup>3</sup> /H (0.6 Ton per hour)		Ⓑ External diameter 32Ø Internal diameter 25Ø
Heat deflection temperature	PP 90°C ~ 100°C	Slit width	0.5mm × 36EA × 2 0.25mm × 36EA × 2
	ABS 86°C		
Materials	Polypro pylene (Coprene complex P.P) Acrylonitrile butadiene styrene (ABS 740)		

### Test tank pressure 2K

- When the pressure applied, the flow rates were approx. 1.0m<sup>3</sup>/H (1.0 Ton per hour) and 0.6m<sup>3</sup>/H (0.6 Ton per hour).
- Remove foreign substances when insufficient flow rate while using the strainer

# MSS-FOR FILTERING

Model : MS1000D

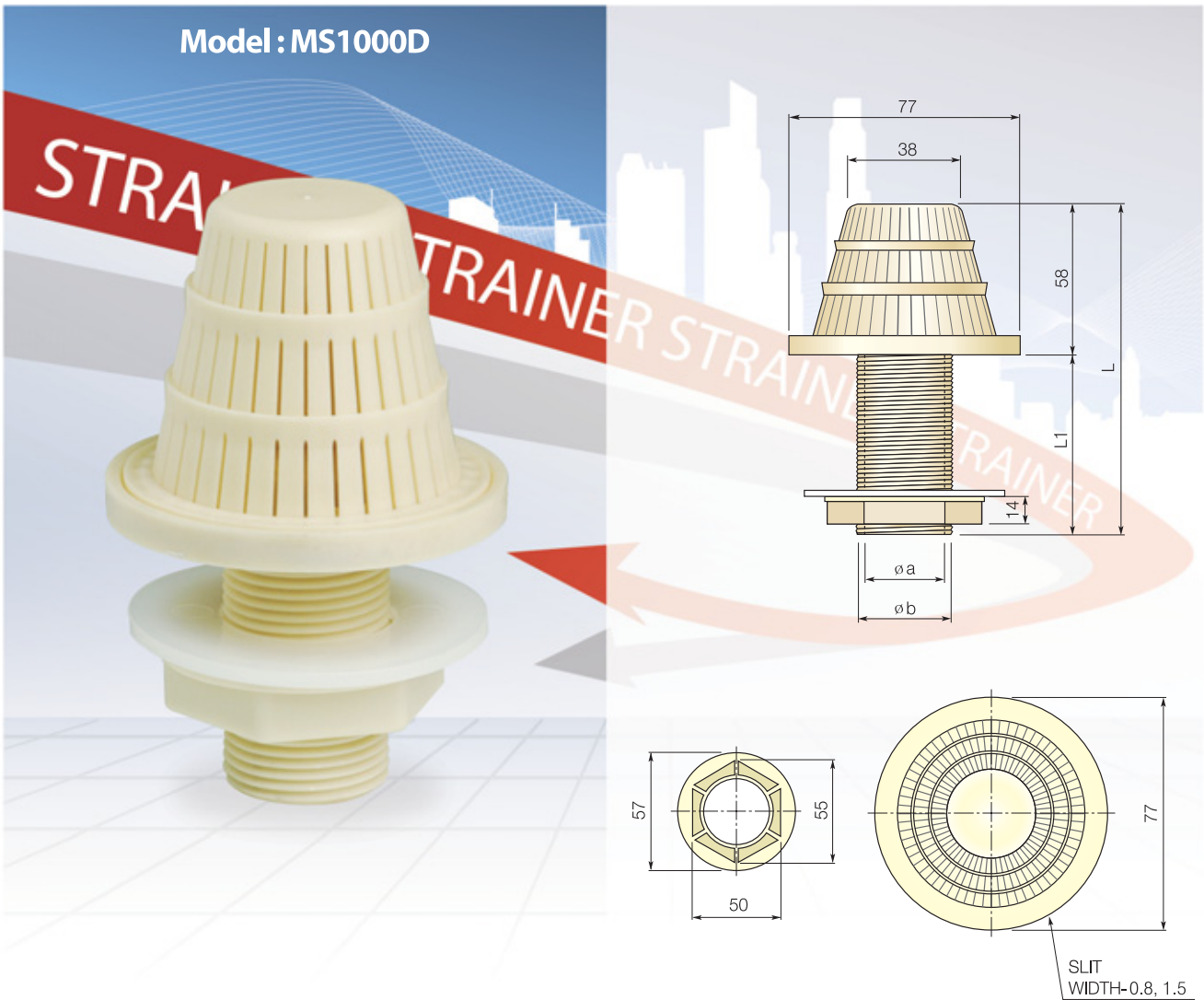

## Strainer specifications and design requirements

Name	MSS Strainer for filtering	Height	L-113mm
Type	Parasol close type		L1-55mm
Use	For filter	Port diameters	Ⓐ External diameter 26Ø Internal diameter 20Ø
Flow rate	1.5m <sup>3</sup> /H (1.5 Ton per hour) 2.0m <sup>3</sup> /H (2.0 Ton per hour)		Ⓑ External diameter 32Ø Internal diameter 25Ø
Heat deflection temperature	PP 90°C ~ 100°C	Slit width	0.8mm × 32EA × 3 1.5mm × 32EA × 3
	ABS 86°C		
Materials	Polypropylene (Coprope complex P.P) Acrylonitrile butadiene styrene (ABS 740)		

### Test tank pressure 2K

- When the pressure applied, the flow rates were approx. 1.5m<sup>3</sup>/H (1.5 Ton per hour) and 2.0m<sup>3</sup>/H (2.0 Ton per hour).
- Remove foreign substances when insufficient flow rate while using the strainer

# MSS-SEPARABLE TYPE

Model : MS1000E

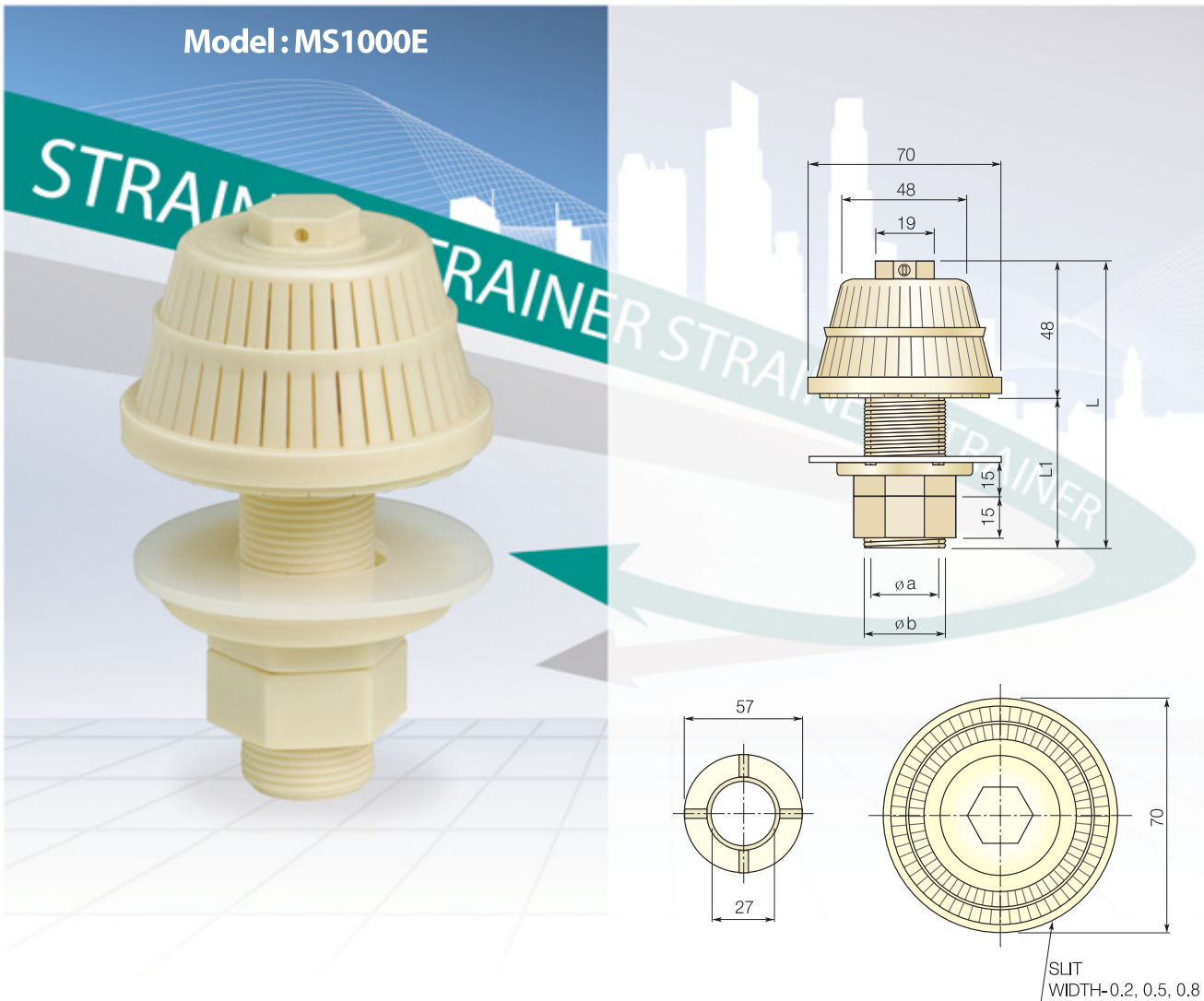

## Strainer specifications and design requirements

Name	MSS SL2, SL5 Separable type	Height	L-118mm, 128mm
Type	Parasol close type		L1-70mm, 80mm
Use	Purifying and filtering of ion resin	Port diameters	Ⓐ External diameter 26Ø Internal diameter 18Ø
Flow rate	0.6m <sup>3</sup> /H (0.6 Ton per hour) SL2 1.0m <sup>3</sup> /H (1.0 Ton per hour) SL5 1.5m <sup>3</sup> /H (1.5 Ton per hour) SL8		Ⓑ External diameter 32Ø Internal diameter 24Ø
Heat deflection temperature	PP 90°C ~ 100°C ABS 86°C	Slit width	0.2mm, 0.5mm × 40EA × 2 0.8mm × 38EA × 2
Materials	Polypropylene (Coprope complex P.P) Acrylonitrile butadiene styrene (ABS 740)		

### Test tank pressure 2K

- When the pressure applied, the flow rates were SL2 : 0.6m<sup>3</sup>/H (0.6 Ton per hour), SL5 : 1.0m<sup>3</sup>/H (1.0 Ton per hour), and SL8 : 1.5m<sup>3</sup>/H (1.5 Ton per hour).
- Remove foreign substances when insufficient flow rate while using the strainer



# MSS-SEPARABLE TYPE S

Model : MS1000S

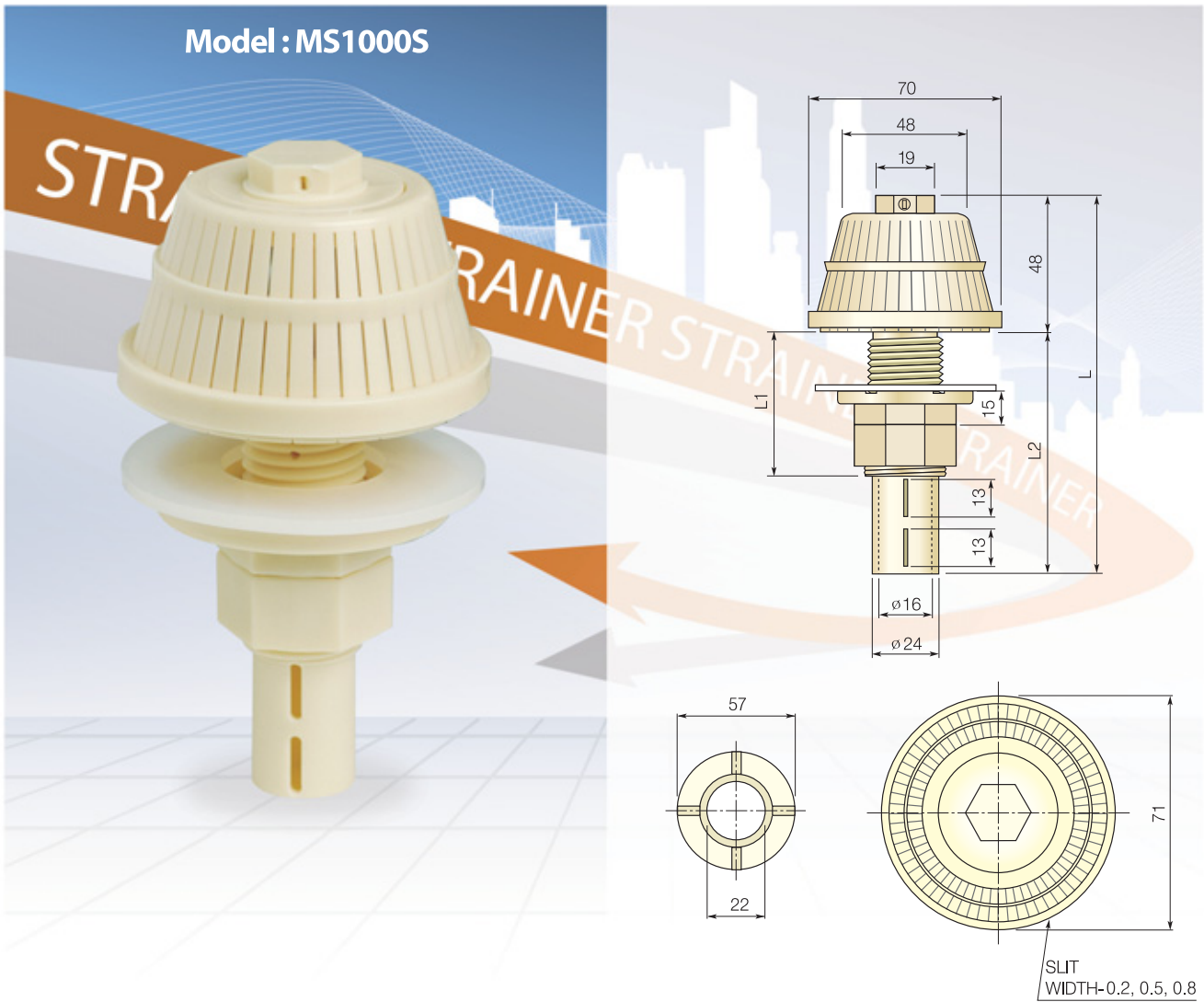

## Strainer specifications and design requirements

Name	MSS separable water to air type	Height	L-128mm
Type	Parasol close type		L1-50mm
Use	Purifying and filtering of ion resin		L2-80mm
Flow rate	0.6m <sup>3</sup> /H (0.6 Ton per hour) SL0.2 1.0m <sup>3</sup> /H (1.0 Ton per hour) SL0.5 1.5m <sup>3</sup> /H (1.5 Ton per hour) SL0.8	Port diameters	External diameter 24Ø Internal diameter 16Ø
Heat deflection temperature	PP 90°C ~ 100°C ABS 86°C	Slit width	0.2mm, 0.5mm × 40EA × 2 0.8mm × 38EA × 2
Materials	Polypropylene (Coprope complex P.P) Acrylonitrile butadiene styrene (ABS 740)		

### Test tank pressure 2K

- When the pressure applied, the flow rates were SL0.2 : 0.6m<sup>3</sup>/H (0.6 Ton per hour), SL0.5 : 1.0m<sup>3</sup>/H (1.0 Ton per hour), and SL0.8 : 1.5m<sup>3</sup>/H (1.5 Ton per hour).
- Remove foreign substances when insufficient flow rate while using the strainer

# MSS-SEPARABLE TYPE S-01

Model : MS1000J

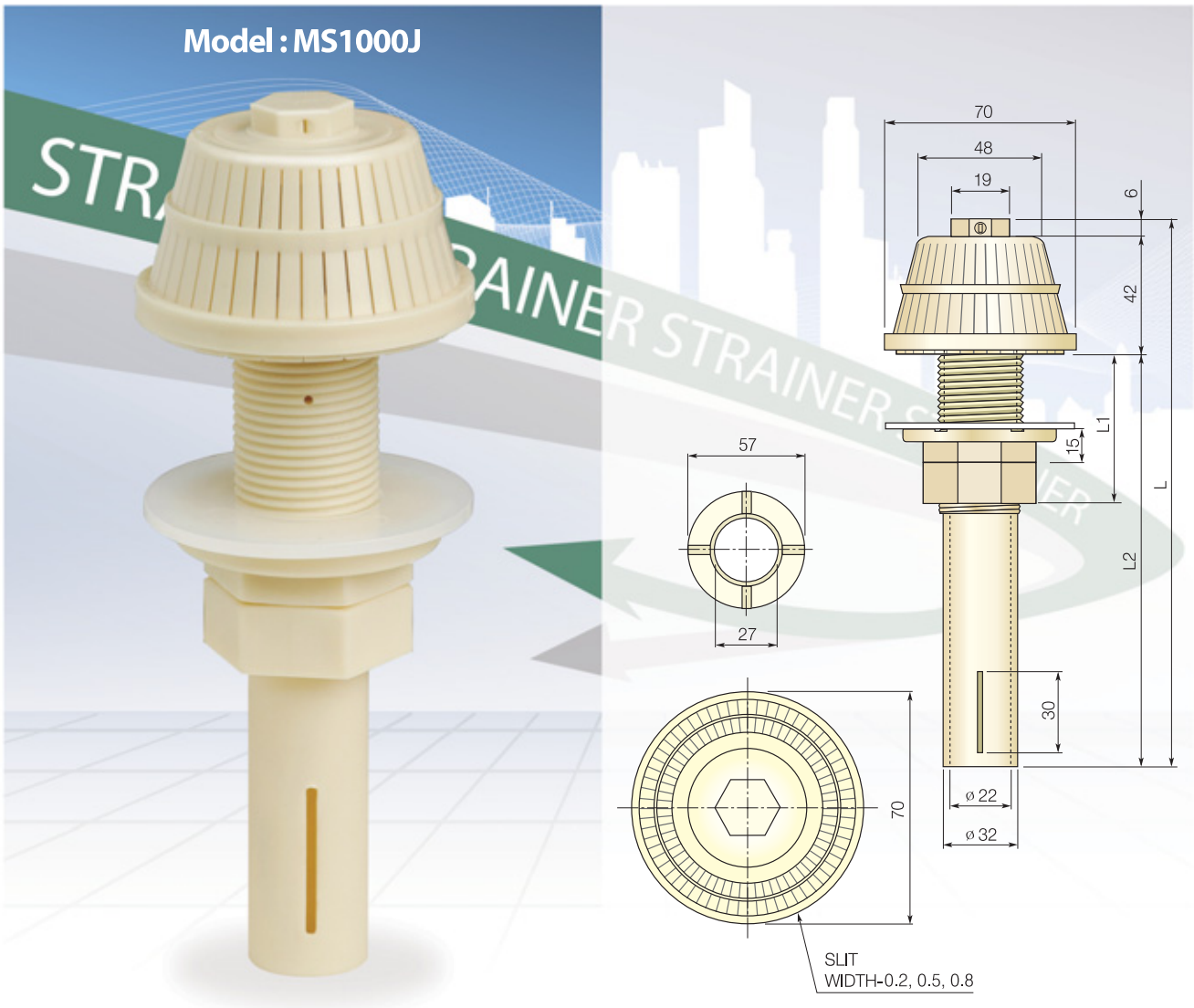

## Strainer specifications and design requirements

Name	MSS Separable water to air type	Height	L-188mm, 248mm
Type	Parasol close type		L1-70mm
Use	Purifying and filtering of ion resin		L2-140mm, 200mm
Flow rate	0.6m <sup>3</sup> /H (0.6 Ton per hour) SL2 1.0m <sup>3</sup> /H (1.0 Ton per hour) SL5 1.5m <sup>3</sup> /H (1.5 Ton per hour) SL8	Port diameters	Ⓐ External diameter 24Ø Internal diameter 16Ø
			Ⓑ External diameter 32Ø Internal diameter 22Ø
Heat deflection temperature	PP 90°C ~ 100°C ABS 86°C	Slit width	0.2mm, 0.5mm × 40EA × 2 0.8mm × 38EA × 2
Materials	Polypropylene (Coprolyene complex P.P) Acrylonitrile butadiene styrene (ABS 740)		

### Test tank pressure 2K

- When the pressure applied, the flow rates were SL2 : 0.6m<sup>3</sup>/H (0.6 Ton per hour), SL5 : 1.0m<sup>3</sup>/H (1.0 Ton per hour), and SL8 : 1.5m<sup>3</sup>/H (1.5 Ton per hour).
- Remove foreign substances when insufficient flow rate while using the strainer



# MSS-SEPARABLE TYPE S-02

Model : MS1000TS

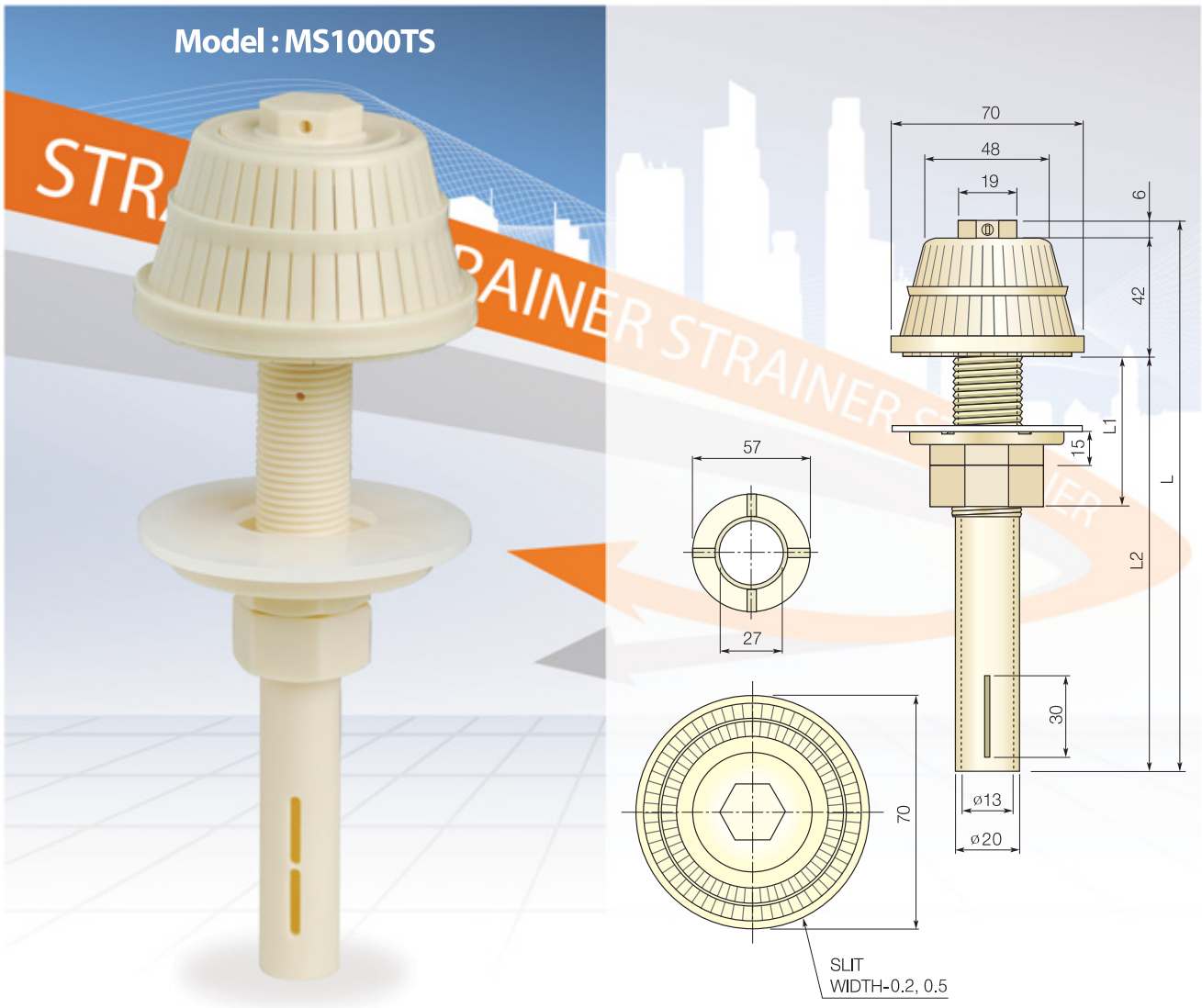

## STRAINER 사양 및 설계조건표

Name	MSS Separable water to air type	Height	L-188mm
Type	Parasol close type		L1-70mm
Use	Purifying and filtering of ion resin		L2-140mm
Flow rate	0.5m <sup>3</sup> /H (0.5 Ton per hour) SL2	Port diameters	External diameter 20Ø Internal diameter 13Ø
	0.8m <sup>3</sup> /H (0.8 Ton per hour) SL5		
Heat deflection temperature	PP 90°C ~ 100°C ABS 86°C	Slit width	0.2mm, 0.5mm × 40EA × 2
Materials	Polypropylene (Coprolyene complex P.P) Acrylonitrile butadiene styrene (ABS 740)		

### Test tank pressure 2K

- When the pressure applied, the flow rates were SL2 : 0.5m<sup>3</sup>/H (0.5 Ton per hour), SL5 : 0.8m<sup>3</sup>/H (0.8 Ton per hour).
- Remove foreign substances when insufficient flow rate while using the strainer

# MSS-INJECTION TYPE

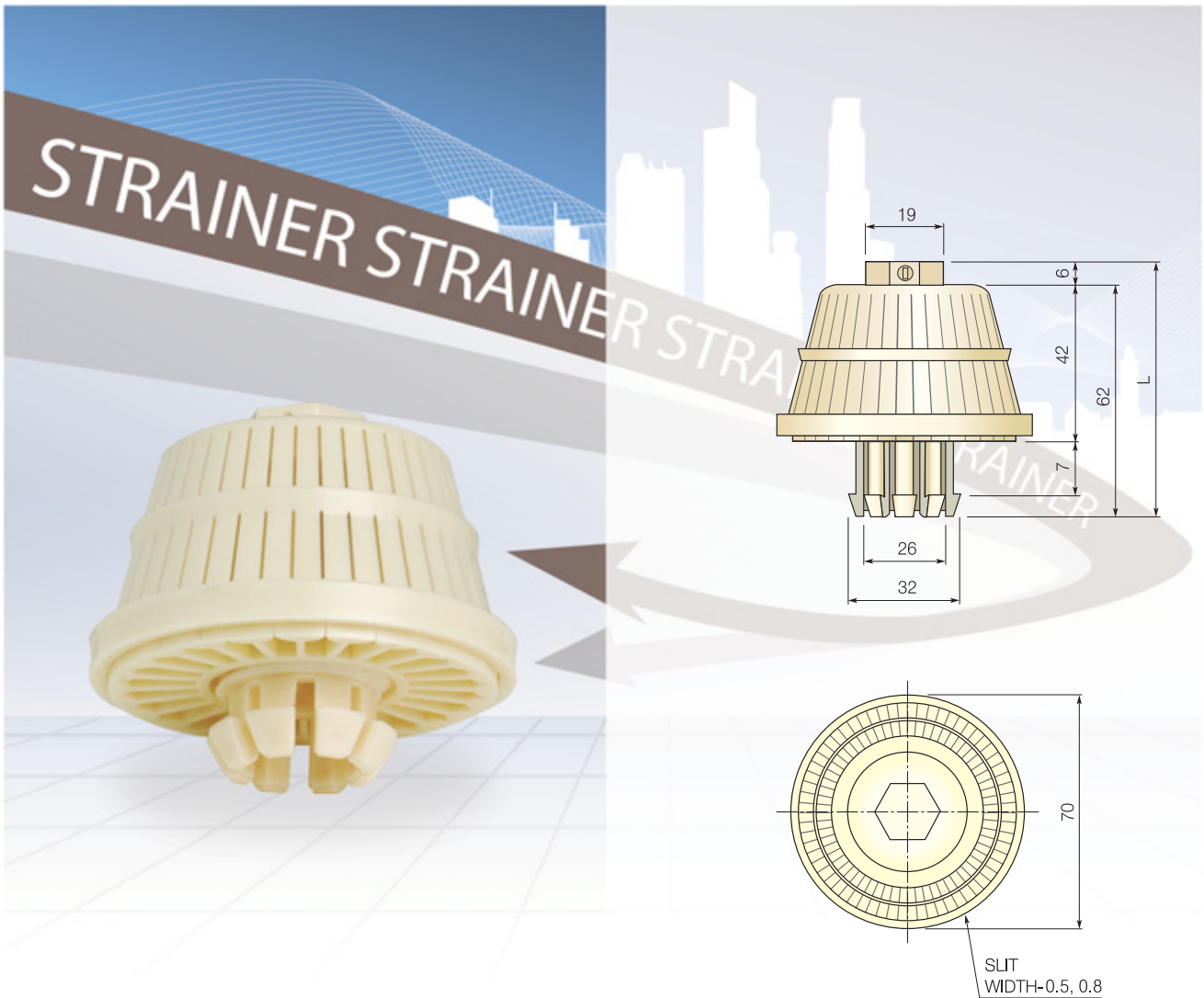

## Strainer specifications and design requirements

Name	MSS Injection type	Height	L-68mm
Type	Parasol close type	Diameter	70mm
Use	Clean water and filtering	Port diameters	External diameter 20Ø
Flow rate	1.0m <sup>3</sup> /H (1.0 Ton per hour) SL5	SLIT WIDTH	0.5mm × 40EA × 2 0.8mm × 38EA × 2
	1.5m <sup>3</sup> /H (1.5 Ton per hour) SL8		
Heat deflection temperature	PP 90°C ~ 100°C		
Materials	Polypro pylene (Coprene complex P.P)		

### Test tank pressure 2K

- When the pressure applied, the flow rates were SL5 : 1.0m<sup>3</sup>/H (1.0 Ton per hour), SL8 : 1.5m<sup>3</sup>/H (1.5 Ton per hour).
- Remove foreign substances when insufficient flow rate while using the strainer

# MSS-DISC SEPARABLE TYPE

Model : MS1000F

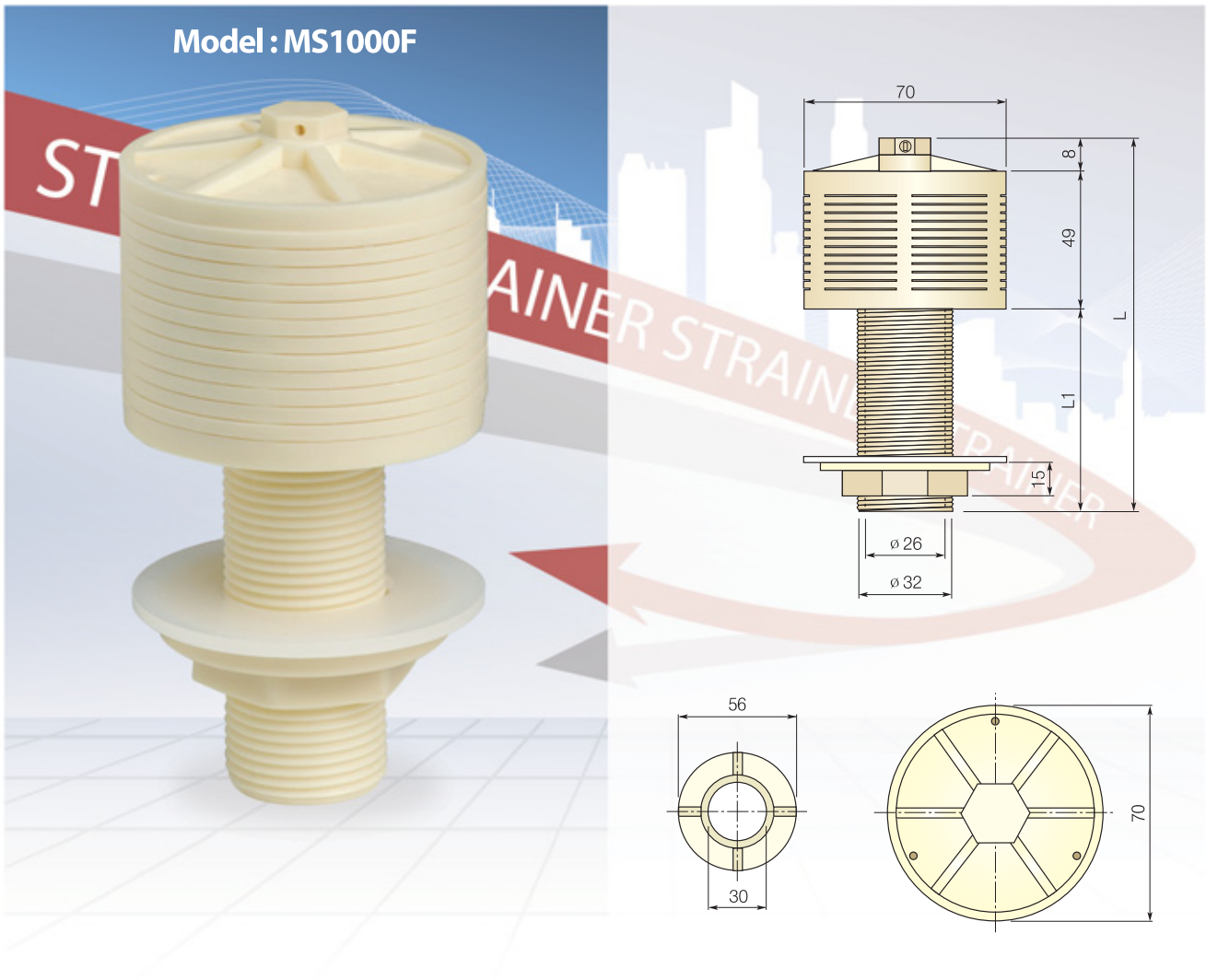

## Strainer specifications and design requirements

Name	MSS Disc separable type	Height	L-132mm L1-75mm
Type	Tube type		
Use	Purifying and filtering of ion resin	Port diameters	External diameter 32Ø Internal diameter 26Ø
Flow rate	0.6m <sup>3</sup> /H (0.6 Ton per hour) SF0.25 1.0m <sup>3</sup> /H (1.0 Ton per hour) SF0.5		
Heat deflection temperature	PP 90°C ~ 100°C ABS 86°C	Slit width	0.25mm 0.5mm
Materials	Polypropylene (Coprolyene complex P.P) Acrylonitrile butadiene styrene (ABS 740)		

### Test tank pressure 2K

- When the pressure applied, the flow rates were SF0.25 : 0.6m<sup>3</sup>/H (0.6 Ton per hour), SF0.5 : 1.0m<sup>3</sup>/H (1.0 Ton per hour).
- Remove foreign substances when insufficient flow rate while using the strainer



# MSS-W FOR PURE WATER

Model : MS1000B

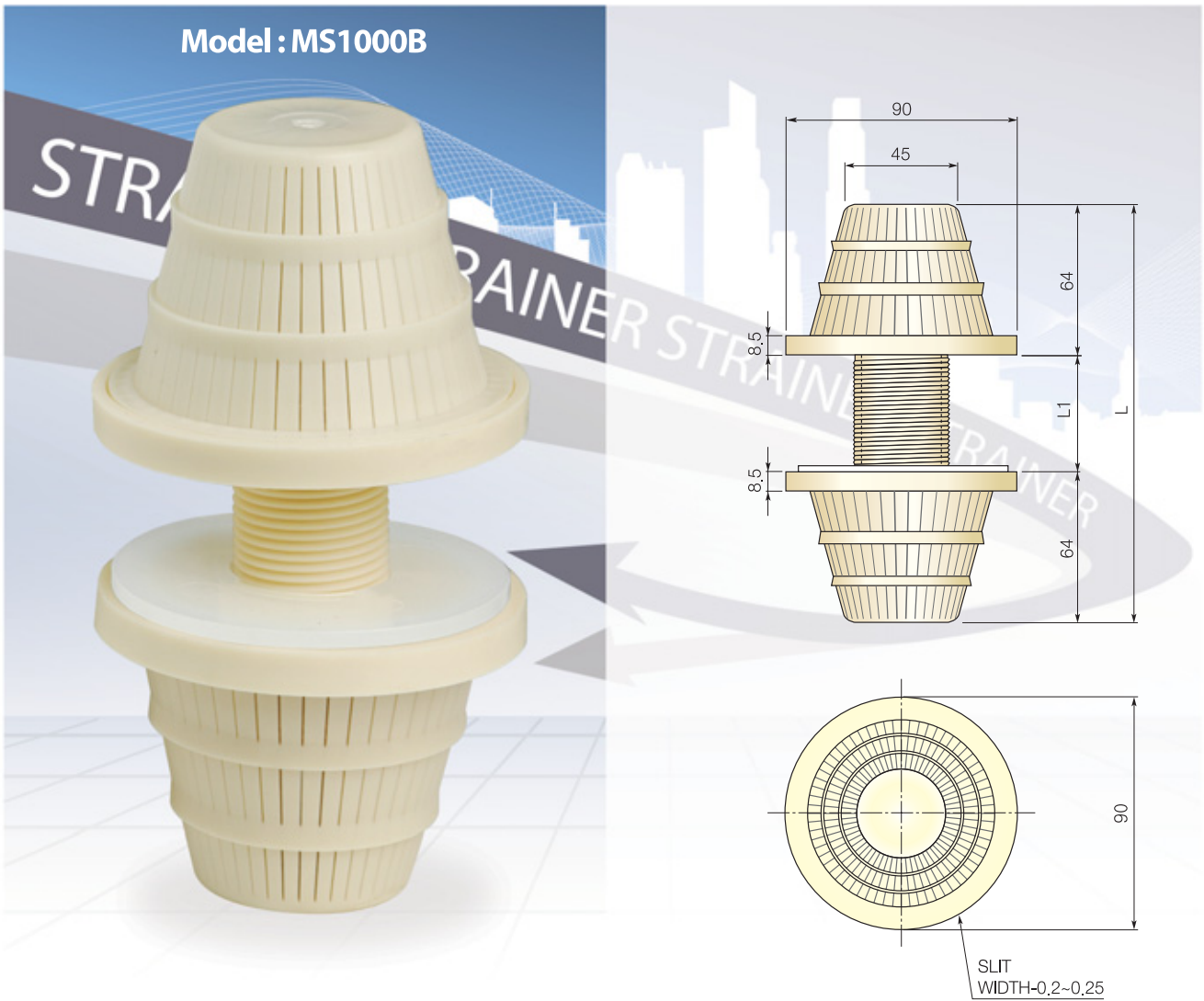

## Strainer specifications and design requirements

Name	MSS W Strainer for pure water	Height	L-140 ~ 170mm
Type	Parasol close type		L1-50mm
Use	For ion resin	Port diameters	External diameter 32Ø Internal diameter 25Ø
Flow rate	1.2m <sup>3</sup> /H (1.2 Ton per hour)		
Heat deflection temperature	PP 90°C ~ 100°C	Slit width	0.25mm(Double) × 45EA × 3
	ABS 86°C		
Materials	Polypropylene (Coprope complex P.P) Acrylonitrile butadiene styrene (ABS 740)		

### Test tank pressure 2K

- When the pressure applied, the flow rates were 1.2m<sup>3</sup>/H (1.2 Ton per hour).
- Remove foreign substances when insufficient flow rate while using the strainer.

# MSS-BLOCK TYPE

Model : MS1000SM

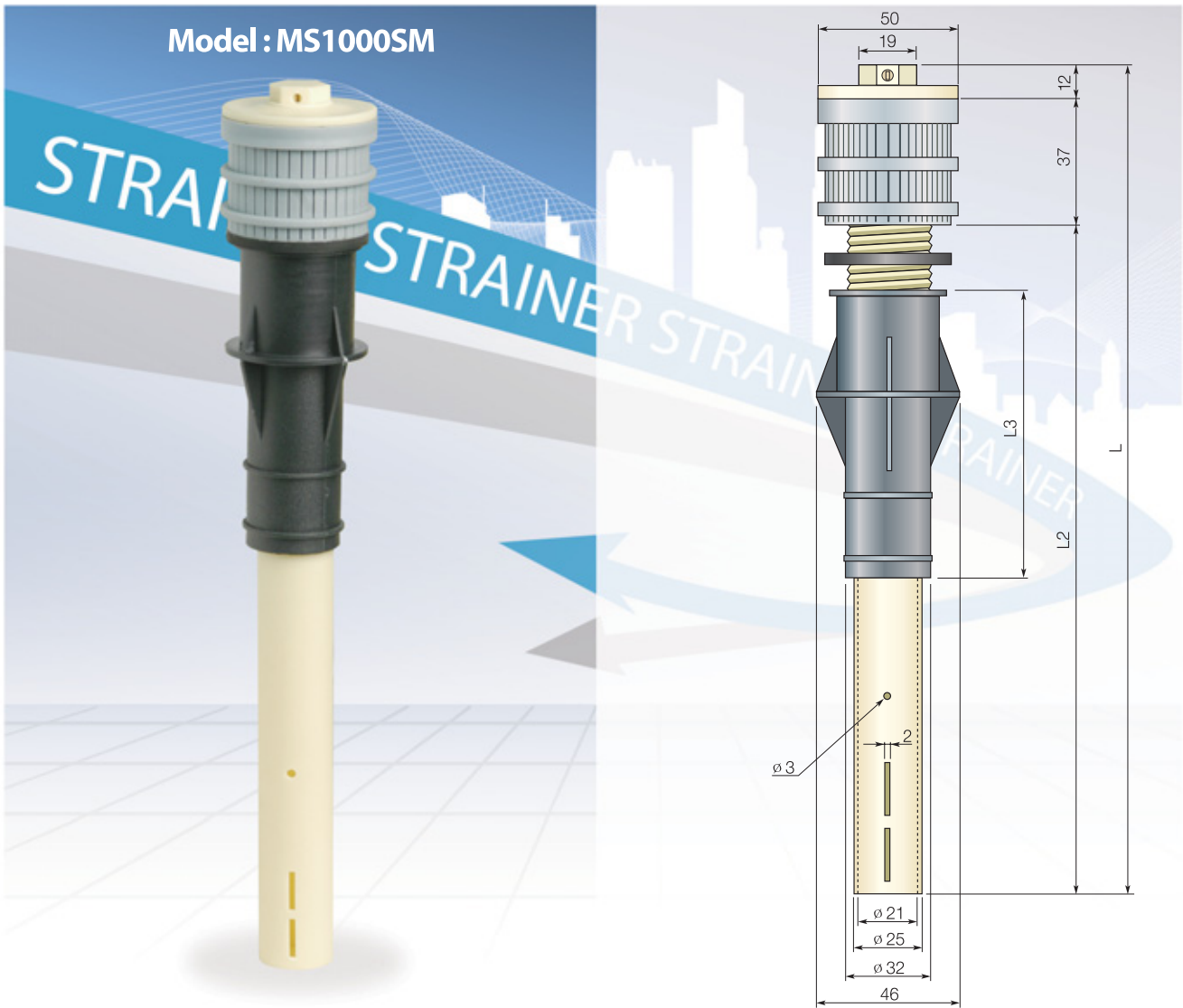

## Strainer specifications and design requirements

Name	MSS Block type	Height	L-295mm
Type	Water to Air	Height	L2-246mm
Use	Clean water and filtering	Sleeve	L3-100mm
Flow rate	0.6m <sup>3</sup> /H (0.6 Ton per hour)	Port diameters	Ⓐ External diameter 32Ø Internal diameter 21Ø
Heat deflection temperature	PP 90°C ~ 100°C		Ⓑ External diameter 25Ø Internal diameter 15Ø
	ABS 86°C	Slit width	0.5mm × 36EA × 3
Materials	Polypro pylene (Coprene complex P.P) Acrylonitrile butadiene styrene (ABS 740)		

■ Remove foreign substances when insufficient flow rate while using the strainer.

# MSS-BLOCK TYPE

Model : MS1000T

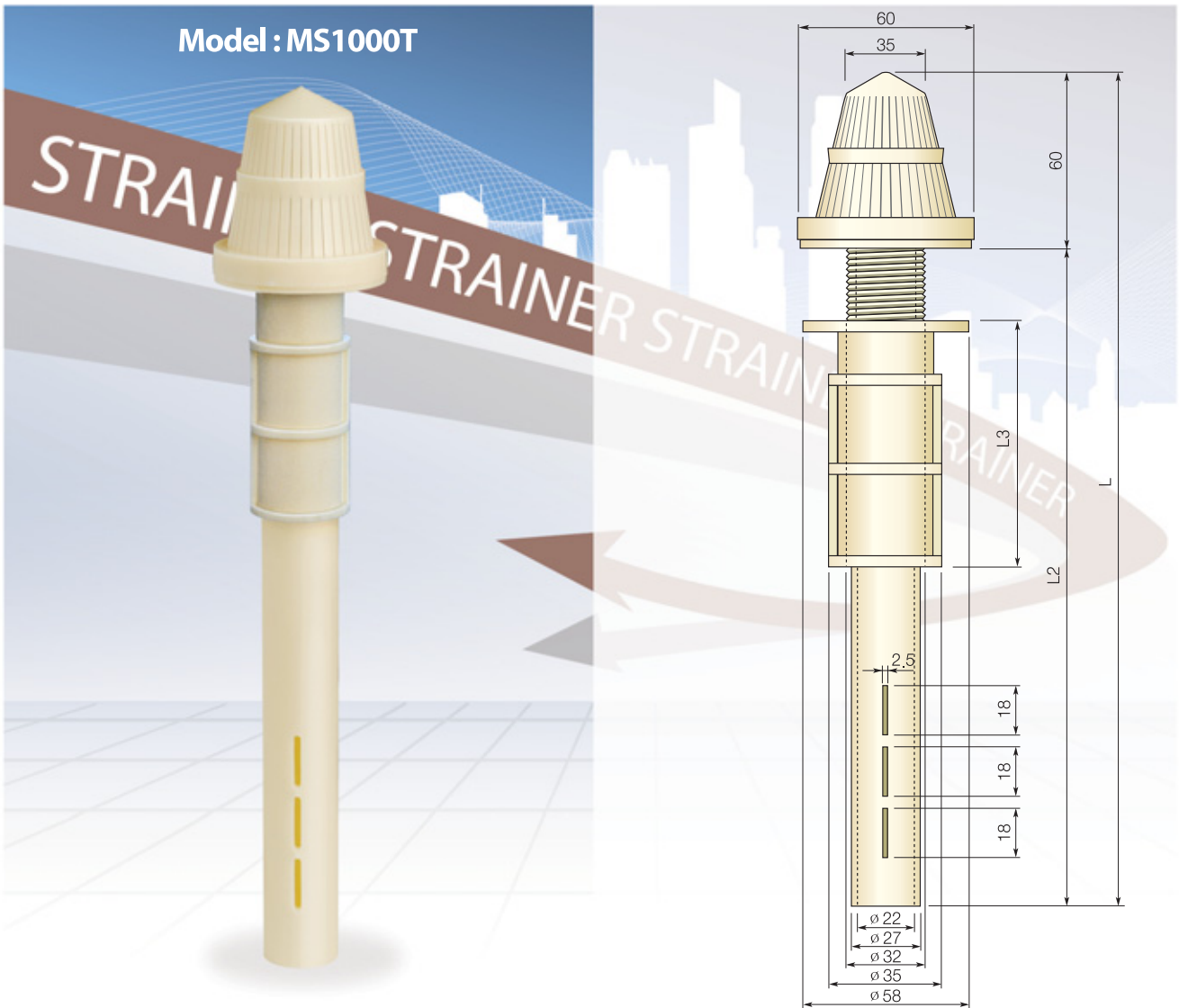

## Strainer specifications and design requirements

Name	MSS Block type	Height	L-300mm
Type	Water to Air		L2-240mm
Use	Clean water and filtering	Sleeve	L3-100mm
Flow rate	1.5m <sup>3</sup> /H (1.5 Ton per hour)	Port diameters	External diameter 32Ø Internal diameter 22Ø
Heat deflection temperature	ABS 86°C		Slit width
Materials	Acrylonitrile butadiene styrene (ABS 740)		

■ Remove foreign substances when insufficient flow rate while using the strainer.



# MSS-SUS STRAINER

Model : MS1000L

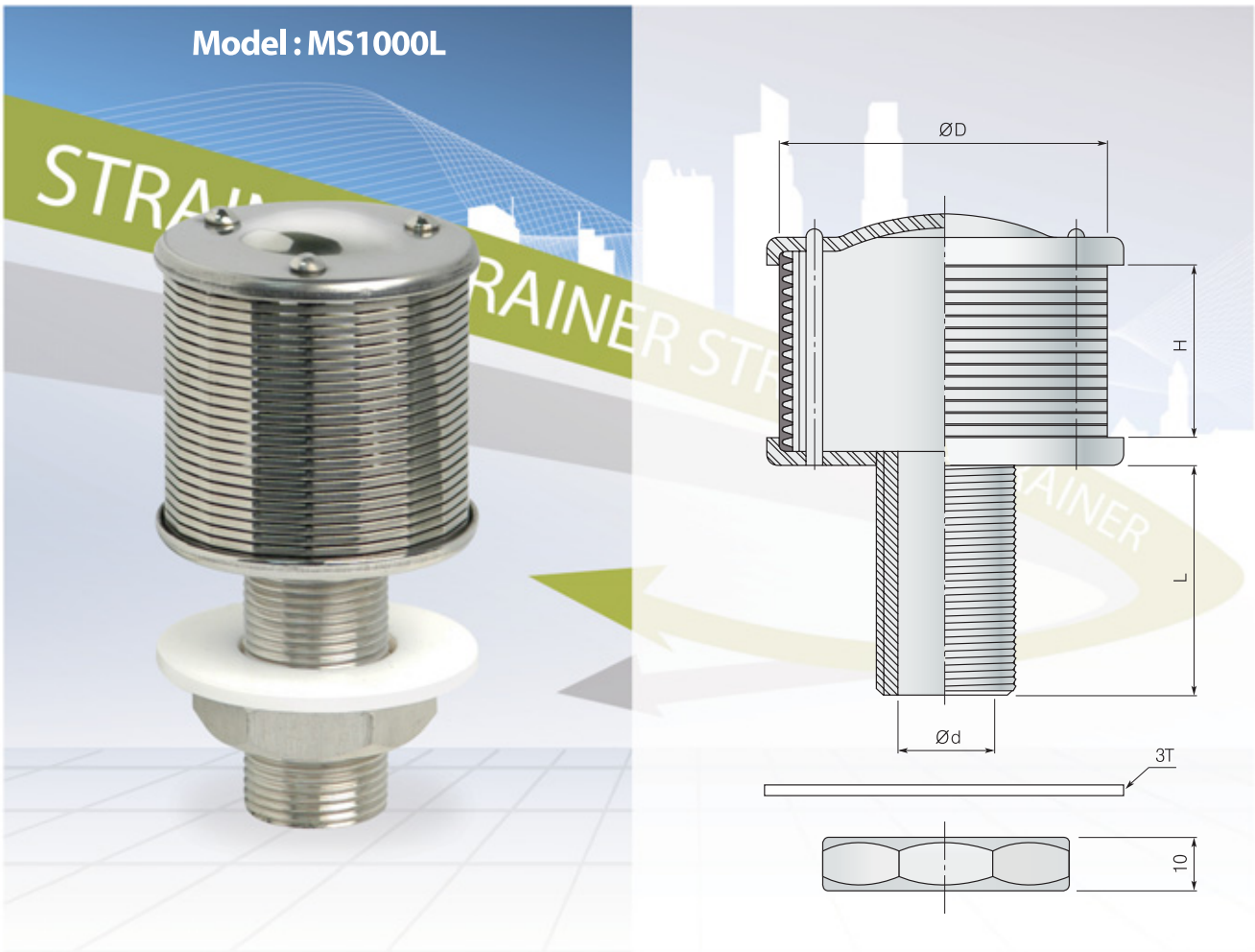

## Strainer specifications and design requirements

Name	MSS SUS Strainer	Height	L-116mm
Type	Tube type	Diameter	56mm
Use	Purifying and filtering of ion resin	Weight	300g
Flow rate	1.5m <sup>3</sup> /H (1.5 Ton per hour)	Port diameters	External diameter 26Ø Internal diameter 20Ø
Materials	SUS304	Slot	0.2, 0.5, 0.8

## Strainer dimension

MODL	SLOT	ØD	H	L	Ød
NO1000L	0.2, 0.5, 0.8	56	45	50	20

- Resolving irrationality in damage on the existing strainer (ABS, PP) and forming accurate slots improve pressure loss and filtering effect through even filtering and back wash.
- Slots are adjustable according to the specifications.

# MSS-SUS STRAINER

Model : MS1000G

STRAINER STRAINER STRAINER STRAINER STRAINER

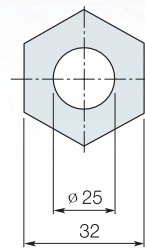
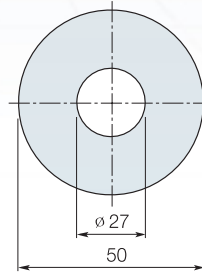
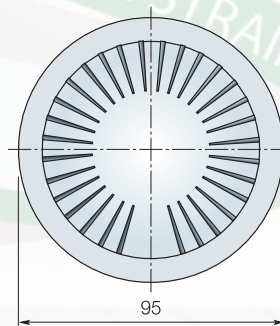
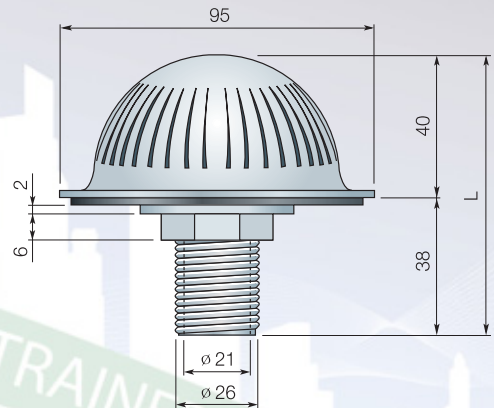

## Strainer specifications and design requirements

Name	MSS SUS Strainer	Height	L-78mm
Type	Dome type	Diameter	95mm
Use	Filtering of clean water	Weight	183g(Nut Gasket inclusion)
Flow rate	0.6m <sup>3</sup> /H (0.6 Ton per hour)	Port diameters	External diameter 26Ø Internal diameter 21Ø
Materials	SUS304	Slit width	0.3mm × 38EA

### Test tank pressure 2K

- When the pressure applied, the flow rates were 0.6m<sup>3</sup>/H (0.6 Ton per hour).
- Remove foreign substances when insufficient flow rate while using the strainer.

# MSS-SUS STRAINER

Model : MS1000I

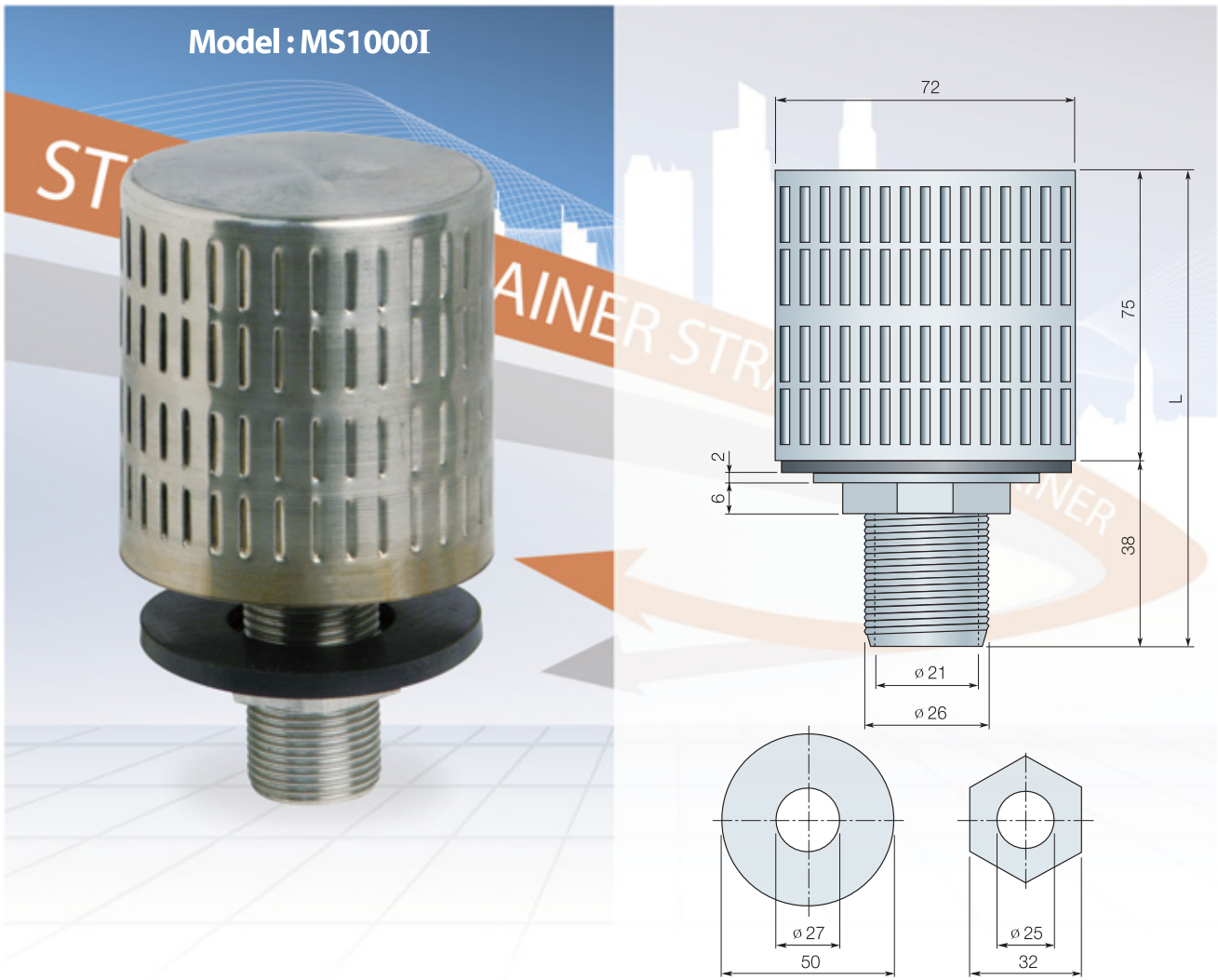

## Strainer specifications and design requirements

Name	MSS SUS Strainer	Height	L-113mm
Type	Tube type	Diameter	72mm
Use	Filtering of clean water	Weight	250g(Nut Gasket inclusion)
Flow rate	2.0m <sup>3</sup> /H (2.0 Ton per hour)	Port diameters	External diameter 26Ø Internal diameter 21Ø
Materials	SUS304	Slit width	0.25 - 0.3mm × 38EA × 4

### Test tank pressure 2K

- When the pressure applied, the flow rates were 2.0m<sup>3</sup>/H (2.0 Ton per hour).
- Remove foreign substances when insufficient flow rate while using the strainer.



# MSS-AIR DIFFUSER DATA SHEET

## Product description



## Strainer specifications and design requirements

Name	MSS 190L Diffuser	Height	80mm
Type	Disc diffuser – 190L new model	Port diameters	PT-3 / 4B, 20A
Quantity of airflow	100 l /min ~ 150 l /min	Materials	ABS resin, EPDM rubber, Thickness 5mm
Pressure loss	150mmAq	Temperature	50°C ~ 60°C
Interval	300 ~ 400mm Center	Water level	Max. 50m (50kg/cm <sup>3</sup> )
Attaching directions	Flexible to install anywhere : bottom, top, left, right	Use	Oxygen supply, Waste water treatment, Night soil treatment, Domestic sewage, Livestock, Dyeing, Other harmful waste water
Oxygen transfer efficiency	7.5% at water level 4m (see the graph)		
Soluble coral percentage	See the graph	Backdraft prevention	Diffuser equipped with double EPDM device New diffuser model of Triplet Impinging type
Eruption hole diameter	170mm		

### Feature

- High concentration microorganism oxidation (MLSS 6000 P.P.M) available.
- Best features include high concentration soluble oxygen percentage and dynamic agitation.
- No cleaning need through 1-time installation.
- Low price.

# MSS-SPRAY NOZZLE DATA SHEET

## Nozzle model and dimension

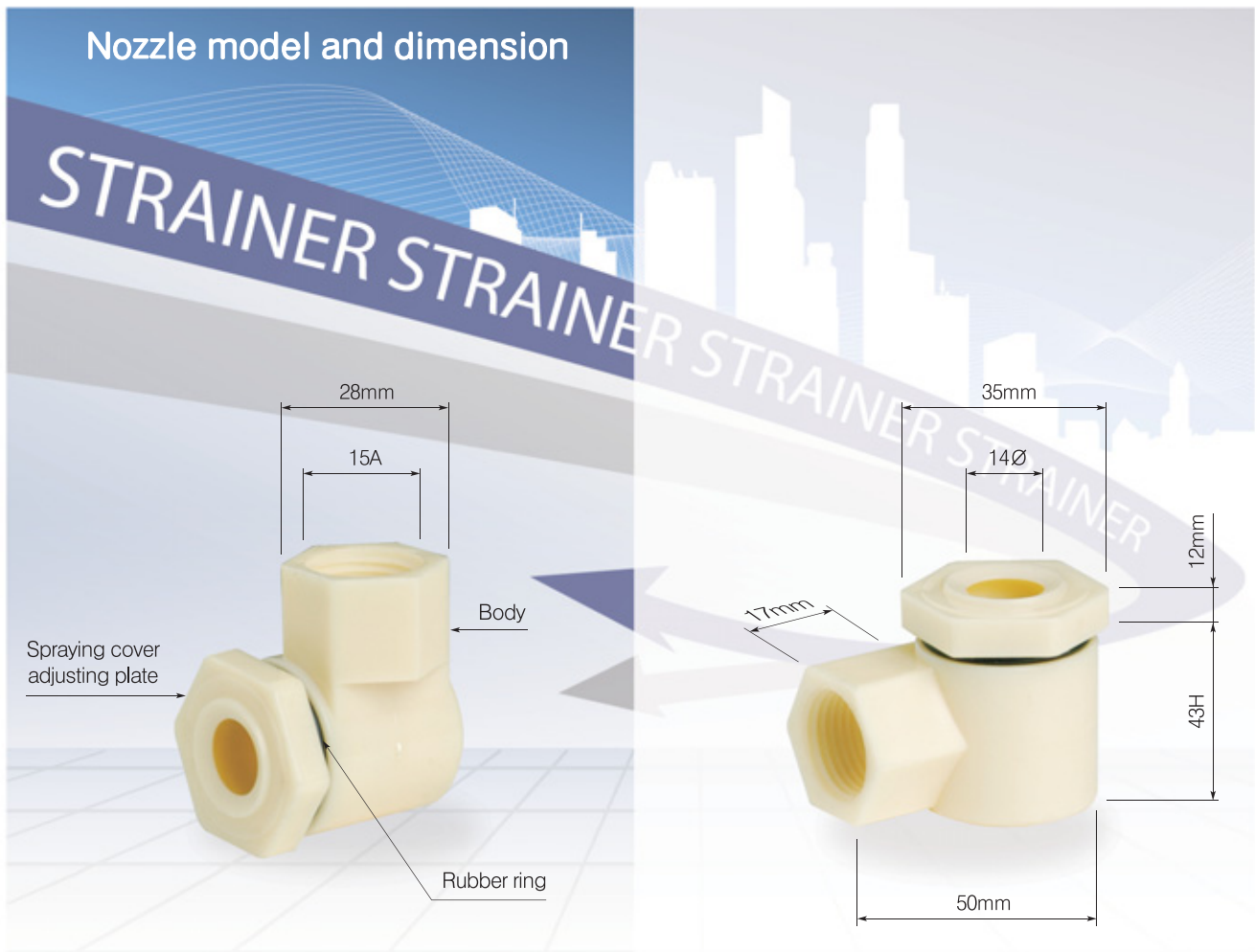

## Strainer specifications and design requirements

Name	MSS Spray nozzle	Spray angel	120° ~ 140°
Type	Centrifugal type MSS 15A	Port diameter	15A(four-tenth) ♀
Use	Removing foams generated in waste water, sewage, night soil treatment facilities and for other uses	Material	ABS resin
		Installation space	500mm or more up from the water surface
Flow rate	8 ℓ /min (8 ~ 10 ℓ /min option available)	Weight	30g
Supply pressure	Max. 1 ~ 1.5kg/cm <sup>3</sup>	Installation direction	140° direction
Pump head	20m	Interval	1000mm ~ 1200mm

### Feature

- High concentration microorganism oxidation (MLSS 6000 P.P.M) available.
- Best features include high concentration soluble oxygen percentage and dynamic agitation.
- No cleaning neede through 1-time installation.
- Low price.



All materials in this catalog are not allowed to use without prior permission.



Strainer manufacturer  
**Myungseong  
Industrial Corp.**

108, Misan-ro, Siheung-si, Gyeonggi-do, Korea  
**TEL : 82-32-611-3490(Rep) FAX : 82-32-611-3491**  
[http : //www.mss21.co.kr](http://www.mss21.co.kr)

**Products** : industrial water strainer, injection molding, purification plant strainer, teflon products